

# BROADWAY 4211-TF

PROJECT PROJÉT
SPEC TYPE
NOTES

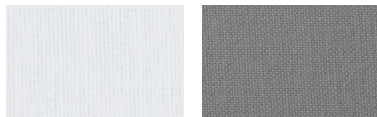

## OPTIONS



WLT (WASHABLE)

GLT (WASHABLE)

## OVERALL HEIGHT HAUTEUR HORS TOUT

LIGHT SOURCE	INC TRACK CIRCUIT	INC	CFL	CFL DIM
MOUNTING	2734B	2401E	2402G	2402J
CABLE	75.60"	75.25"	76.00"	52.50"
STEM	51.00"	50.65"	51.40"	51.90"

## MOUNTING OPTIONS OPTIONS DE MONTAGE

2734B	2401E	2402G	2402J
1.46" x 1.36" 37 x 35mm	Ø4.50" x 1.00" Ø114 x 25mm	Ø5.25" x 1.75" Ø133 x 44mm	Ø5.25" x 2.25" Ø133 x 57mm

\* OVERALL HEIGHT DOES NOT INCLUDE TRACK THICKNESS

## STEM OR CABLE OPTIONS OPTIONS DE TIGE OU CÂBLE

STEM	CABLE
STD 36" 914mm	STD 60" 1523mm

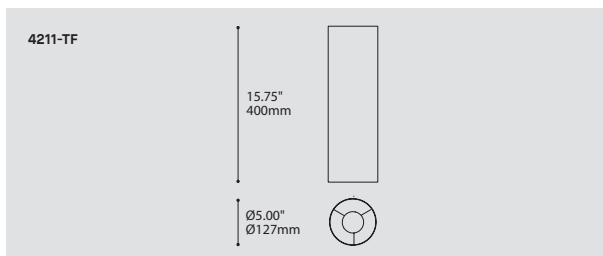

## ORDERING SPECIFICATION SPÉCIFICATION DE COMMANDE

MODEL MODÈLE	CODE
--------------	------

4211-TF BROADWAY 4211-TF

## LIGHT SOURCE SOURCE LUMINEUSE

(WATTAGE, LAMP TYPE, LAMP FORM, BASE TYPE, OTHER INFO)

CF.D.13*		13W, CFL, DOUBLE TWIN TUBE, G24Q1 BASE
CF.D.18*		18W, CFL, DOUBLE TWIN TUBE, G24Q2 BASE
CF.T.26*		26W, CFL, TRIPLE TWIN TUBE, G24Q3 BASE
INC.40		40W, INC, A19 / HAL T10, MEDIUM BASE (120V ONLY)

\*NOT AVAILABLE WITH A TRACK ADAPTOR

## VOLTAGE VOLTAGE

120V	120 VOLT
277V*	277 VOLT
347V**	347 VOLT

\*NOT AVAILABLE WITH A TRACK ADAPTOR  
\*\*ONLY AVAILABLE WITH CF.D.13, CF.D.18 AND CF.T.26 (NON-DIMMING BALLAST)

## DIMMING OPTION OPTION DE GRADATION

AVAILABLE WITH CF.D.18 AND CF.T.26 ONLY, MAXIMUM 36" STEM / CABLE LENGTH

DED	LUTRON ECOSYSTEM ELECTRONIC DIMMING BALLAST (ECOSYSTEM DIGITAL LINK WIRING)
DE3	LUTRON ECOSYSTEM ELECTRONIC DIMMING BALLAST (3-WIRE WIRING)

## STEM OR CABLE TIGE OU CÂBLE

S6	1/4" (6MM) STEM, FIELD ADJUSTABLE (NOT AVAILABLE WITH CFL LAMPS)
S10	3/8" (10MM) STEM, NOT FIELD ADJUSTABLE (FOR CFL LAMPS ONLY)
C	CLEAR CABLE, FIELD ADJUSTABLE

## STEM OR CABLE LENGTH LONGUEUR DE TIGE OU CÂBLE

36	36" STEM (STD LENGTH)
60	60" CABLE (STD LENGTH)
**	CUSTOM STEM LENGTH (PLEASE SPECIFY)
**	CUSTOM CABLE LENGTH (PLEASE SPECIFY)

FOR OVERALL LENGTH PLEASE CONTACT YOUR EUREKA REPRESENTATIVE.

## MOUNTING MONTAGE

RC	 ROUND CANOPY / PAVILLON ROND FOR INC: 1.00" CANOPY (2401E) FOR CFL: 1.75" CANOPY (2402G) FOR DIMMING CFL: 2.25" CANOPY (2402J)
TA1	 TRACK ADAPTOR / ADAPTATEUR DE RAIL 1 CIRCUIT INC 120V ADAPTOR (2734B)

## MOUNTING OPTION OPTION DE MONTAGE

SCA*	SLOPE CEILING ADAPTOR / ADAPTATEUR DE PLAFOND EN PENTE (ROTATION: 350°, PIVOT: 90°)
------	---

\*ONLY AVAILABLE WITH A STEM

## TRACK ADAPTOR FINISH FINI ADAPTATEUR DE RAIL<sup>(A)</sup>

WH	WHITE
BLK	BLACK
M G	METALLIC GRAY

<sup>(A)</sup> FILL IN IF A TRACK ADAPTOR IS SELECTED, OTHERWISE LEAVE EMPTY

## STRUCTURE FINISH FINI STRUCTURE<sup>(B)</sup>

S C	SATIN CHROME
BLK	BLACK
CHR	CHROME
WH	WHITE

<sup>(B)</sup> INCLUDE CANOPY FINISH IF A CANOPY IS SELECTED

## SHADE FINISH FINI ABAT-JOUR

WLT	WHITE - LINEN - TRILAM
GLT	GRAY - LINEN - TRILAM

## PRODUCT CHARACTERISTICS CARACTÉRISTIQUES DU PRODUIT

**DIM** **IES**

DESIGN:	Narrow cylindrical shade, same great proportions and illumination. May be mounted on track, canopy or sloped ceiling adaptor.
LIGHT SOURCE:	A wide range of compact fluorescent and dimmable incandescent available.
STRUCTURE:	Die-stamped steel structure with satin chrome plated finish.
SHADE:	Washable and standard fabric shades in a range of colours.
CERTIFIED:	c-CSA-us

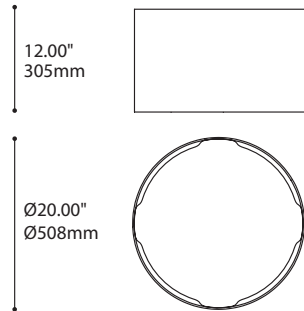

GGU

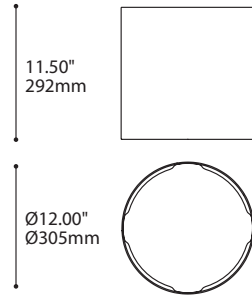

GGL

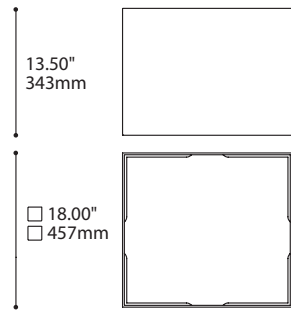

GIS

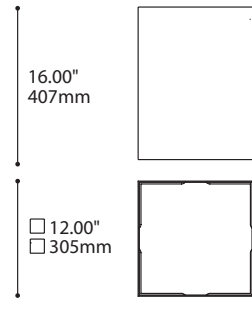

GIL

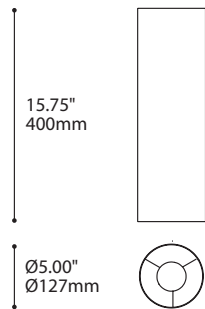

TF (LED NOT AVAILABLE)

**TRILAM FABRIC SHADE**  
Wide variety of shade options available.  
Washable & stain resistant options.  
Ideal for commercial use.

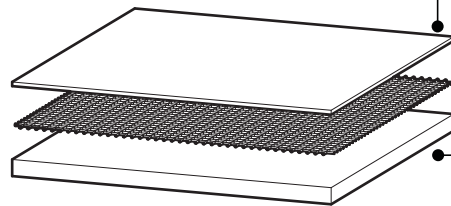

**FIRST LAYER: PROTECTIVE SHIELD**  
Clear polymeric film for durability and washability

**SECOND LAYER: FABRIC**  
High quality linen textile treated with resin

**THIRD LAYER: DIFFUSER**  
Lighting grade translucent white polymer for diffusion

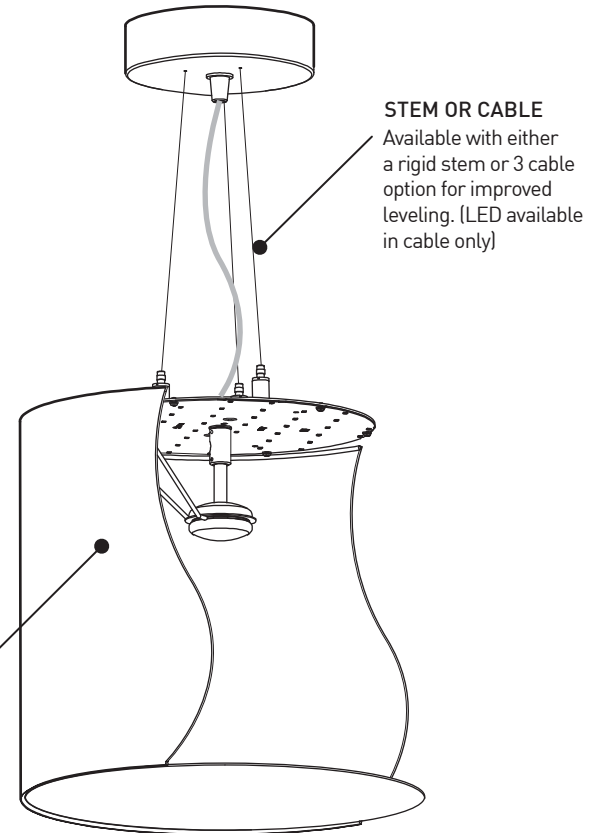

**STEM OR CABLE**  
Available with either a rigid stem or 3 cable option for improved leveling. (LED available in cable only)

## SPECIFICATIONS

### LIGHT SOURCES

CF.D.13  
CF.D.18  
CF.T.26  
CF.SP.26  
INC.40

### GGL | GIL

LED.10.30  
LED.10.40  
CF.D.13  
CF.D.18  
CF.T.26  
CF.SP.26  
INC.100

### GGU | GIS

LED.24.30  
LED.24.40  
CF.D.13  
CF.D.18  
CF.T.26  
CF.SP.26  
INC.100

### DIMMING OPTIONS

DV 0-10V (120-277V), DP PHASE DIMMING (120V), DED, DE3

### VOLTAGE

120V, 277V, 347V (277 not available with track adapter, 347 only with CF)

### LIGHT DISTRIBUTION

Direct and indirect (LED only provides semi-direct)

### STRUCTURE FINISH

Satin chrome, Chrome, Black, White

### SHADE FINISH

White linen, White linen trilam, White fabric box, Gray linen trilam

### DIFFUSER

Acrylic diffuser for LED version

### CERTIFICATION

c-CSA-us , c-UL-us (F.T5.C Circline only)

### WARRANTY

5 year warranty on LED fixture, 2 year warranty on FLOU fixtures

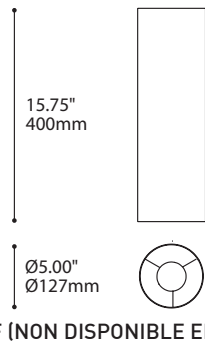
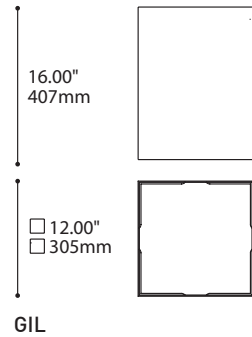
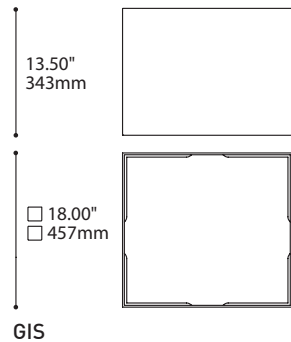
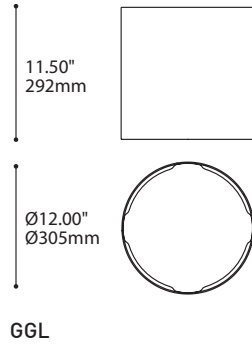
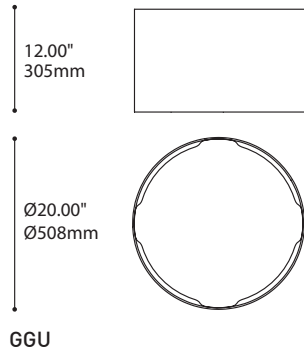

**ABAT-JOUR EN TISSU TRILAM**  
Grande variété d'abat-jour disponible.  
Option de tissus lavable & résistant aux taches.  
Idéale pour utilisation commerciale.

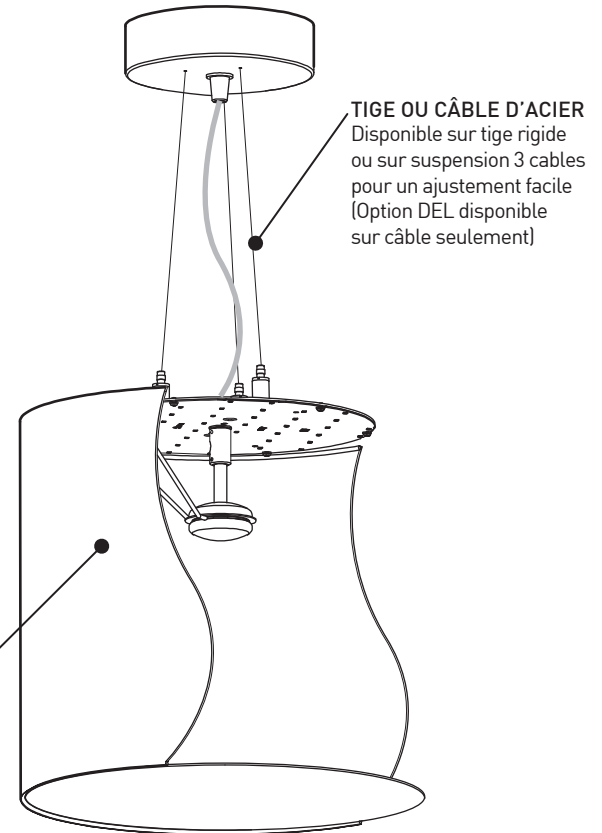
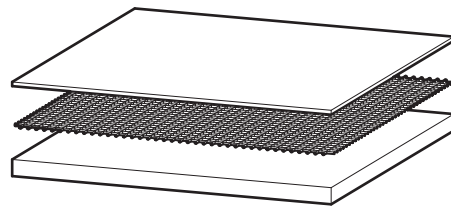

SPECIFICATIONS	TF	GGL   GIL	GGU   GIS
SOURCE LUMINEUSE	CF.D.13 CF.D.18 CF.T.26 CF.SP.26 INC.40	LED.10.30 LED.10.40 CF.D.13 CF.D.18 CF.T.26 CF.SP.26 INC.100	LED.24.30 LED.24.40 CF.D.13 CF.D.18 CF.T.26 CF.SP.26 INC.100
OPTIONS DE GRADATION	DV 0-10V (120-277V), GRADATION DP PHASE (120V), DED, DE3		
VOLTAGE	120V, 277V, 347V (277V non disponible sur système de rail, 347V seulement avec source CF)		
DISTRIBUTION LUMINEUSE	Directe et indirecte (semi-directe seulement pour l'option DEL)		
STRUCTURE	Satin chrome, Chrome, Noir, Blanc		
ABAT-JOUR	Lin tissé blanc, Lin tissé blanc TRILAM, Tissu blanc, Lin gris TRILAM		
DIFFUSEUR	Diffuseur en acrylique pour l'option DEL		
CERTIFICATION	c-CSA-us, c-UL-us (F.T5.C Circulaire seulement)		
GARANTIE	Garantie de 5 ans sur le luminaire en DEL, Garantie de 2 ans sur les luminaires en fluorescent		