

DIAL 2060

PROJECT PROJÉT
SPEC TYPE
NOTES



OPTIONS



BLKE WHE CHR

OVERALL HEIGHT HAUTEUR HORS TOUT

	LED TRACK 1 CIRCUIT	LED 0.50" CANOPY
MOUNTING	2734E	2471C
STEM	39.95"	38.45"

MOUNTING OPTIONS OPTIONS DE MONTAGE



STEM OR CABLE OPTION OPTIONS DE TIGE OU CABLE

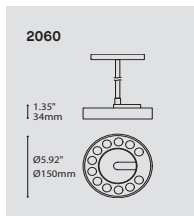
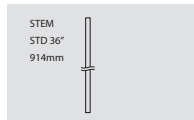

ORDERING SPECIFICATION SPÉCIFICATION DE COMMANDE

MODEL MODÈLE		CODE
2060	DIAL	2060
LIGHT SOURCE SOURCE LUMINEUSE		
LED	REGULAR OUTPUT	
LED.HO	HIGH OUTPUT	
COLOR TEMPERATURE TEMPÉRATURE DE COULEUR		
30	3000K	
35	3500K	
40	4000K	
BEAM ANGLE ANGLE DE FAISCEAU		
NA	NARROW (18°)	
ME	MEDIUM (44°)	
VOLTAGE VOLTAGE		
120V	120 VOLT	
277V	277 VOLT	
DIMMING OPTION OPTION DE GRADATION *		
DV	0-10V DIMMING (120V-277V)	
DP	PHASE DIMMING (120V ONLY)	
LED DIMMING DRIVER IS STANDARD IN THIS PRODUCT, PLEASE SPECIFY YOUR DIMMING TYPE. * 3983 ACCESSORY IS PROVIDED		
STEM TIGE		S10
S10	3/8" (10MM), STEM, NOT FIELD ADJUSTABLE	
STEM LENGTH LONGUEUR DE TIGE		
36	36" STEM (STD LENGTH)	
**	CUSTOM STEM LENGTH (PLEASE SPECIFY)	
FOR OVERALL LENGTH, PLEASE CONTACT YOUR EUREKA REPRESENTATIVE.		
MOUNTING MONTAGE		
RC	ROUND CANOPY / PAVILLON ROND SCREWLESS 0.5" CANOPY (2471C)	
TA1	TRACK ADAPTOR / ADAPTEUR DE RAIL 1 CIRCUIT LED DIMMING 120V ADAPTOR (2734E)	
TRACK ADAPTOR FINISH FINI ADAPTEUR DE RAIL ^(A)		
BLK	BLACK	
WH	WHITE	
^(A) FILL IN IF A TRACK ADAPTOR IS SELECTED, OTHERWISE LEAVE EMPTY.		
CANOPY FINISH FINI PAVILLON		
BLKE	BLACK FINE TEXTURE	
WHE	WHITE FINE TEXTURE	
STRUCTURE FINISH FINI STRUCTURE		BLKE
BLKE	BLACK FINE TEXTURE	
CYLINDER FINISH FINI CYLINDRE		
BLKE	BLACK FINE TEXTURE	
WHE	WHITE FINE TEXTURE	
CHR	CHROME	
ACCESSORY ACCESSOIRE		
3983	DEEP JUNCTION BOX	

PRODUCT CHARACTERISTICS CARACTÉRISTIQUES DU PRODUIT



- DESIGN:** Dial combines an innovative design with a high-performance LED technology. A pivot for suspended application offers 350° of rotation and up to 80° of tilting. Available on various stem lengths to fit any given space.
- INSTALLATION:** Simple installation on stem with screwless canopy. Deep junction box (3983) included.
- LIGHT SOURCE:** LED module composed of 12 high-power LEDs. Offered with standard dimming options 0-10V (DV) or phase (DP).
- STRUCTURE:** Aluminum structure and custom die-cast heatsink with black fine textured finish. CNC machined aluminum exterior ring available in white or black fine textured finishes, or polished chrome.
- OPTIC:** Multiple TIR, available with narrow (18° FWHM) or medium (44° FWHM) beam. Tempered glass masked with black silkscreen printing isolates the optics to improve performance.
- CERTIFIED:** c-CSA-us

ANATOMY



DIAL-SUSPENDED

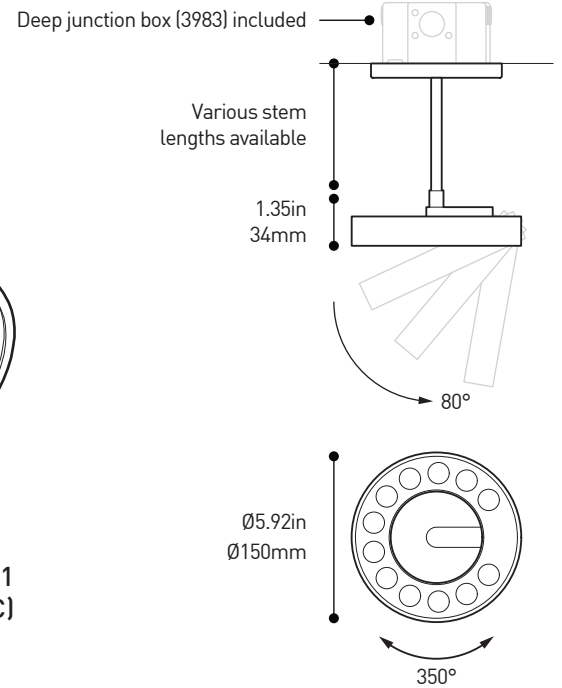
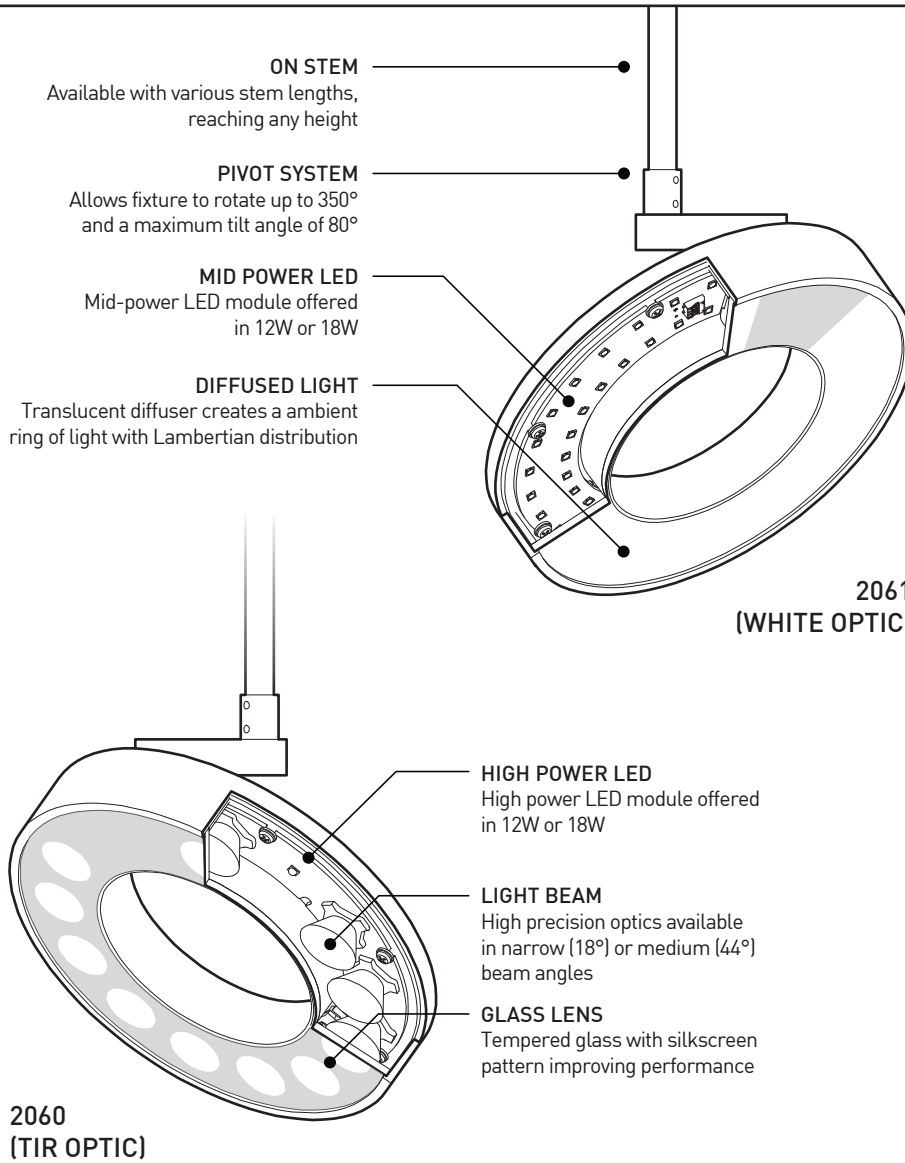

DIRECT PROJECTOR
High precision optics create a tight beam angle

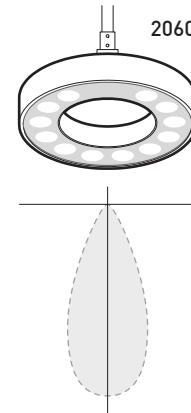

AMBIENT GLOW
Translucent diffuser creates a Lambertian distribution

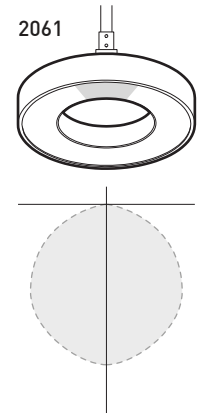

SPECIFICATIONS

	2060 REG	2060 HO	2061 REG	2061 HO
LIGHT SOURCE	12 x High Power LED on MCPCB		48 x Mid power LED on MCPB	
DELIVERED LUMENS	982 lm (4000K)	1318 lm (4000K)	687 lm (4000K)	951 lm (4000K)
SYSTEM WATTAGE	15W Total	22.5W Total	13.6W Total	20.8W Total
OPTICS	Narrow (18°) or medium (44°) FWHM beam angles			
CRI	85 CRI Typical			
CCT	3000K, 3500K or 4000K, 3-step MacAdam ellipse binning			
LIGHT DISTRIBUTION	Directional projector with 80° movement and 350° rotation			
MODULE	UL Recognized - Proprietary design - Made in USA			
HEATSINK	Black diecast aluminum			
VOLTAGE	120V or 277V			
DIMMING	Phase dimming (DP) or 0-10V dimming (DV)			
WARRANTY	5 years			



225 de Liège Ouest, Suite #200
Montréal (QC), Canada H2P 1H4
Tel : 514.385.3515 Fax : 514.385.4169
www.eurekalighting.com



2060
2061

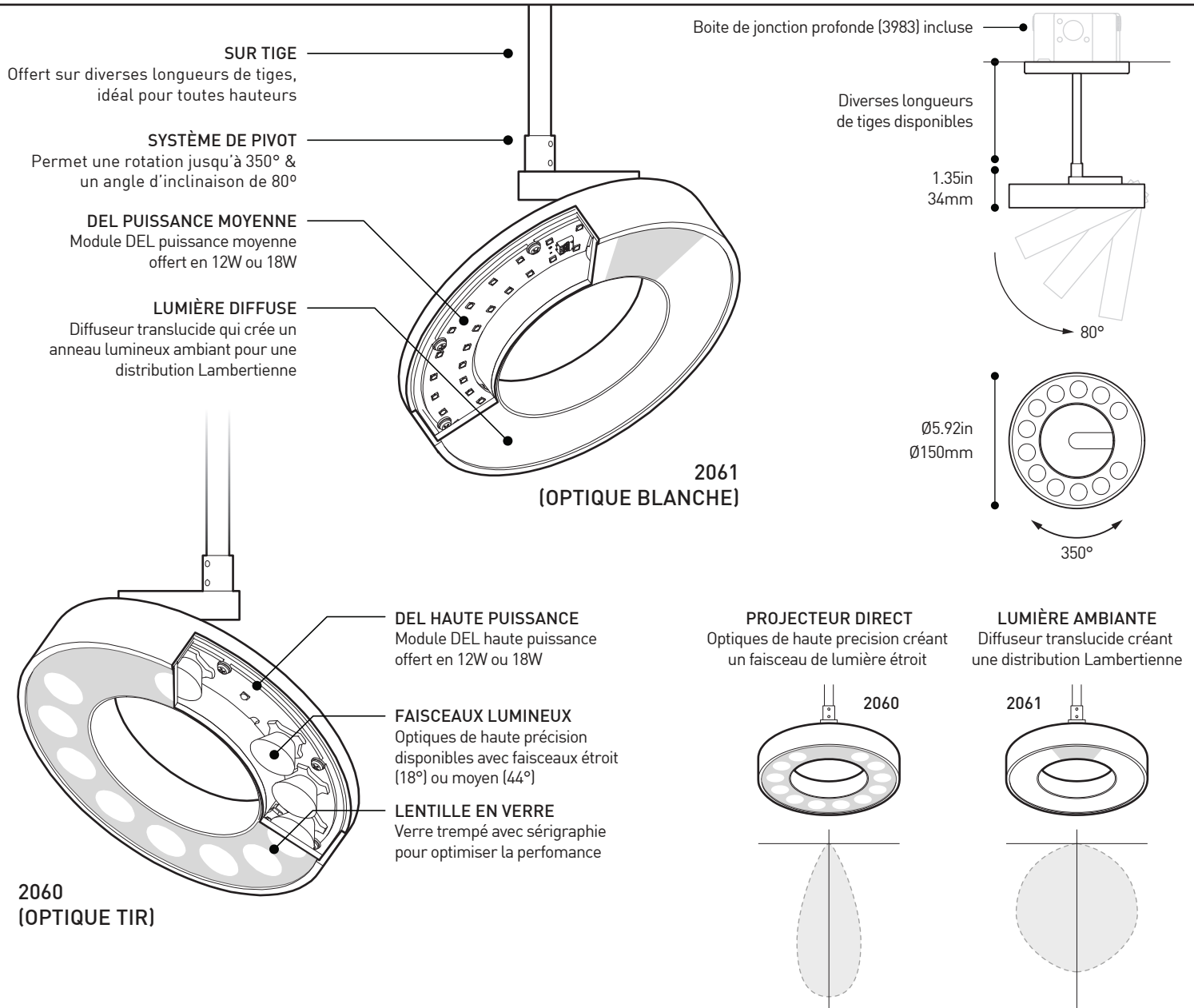

SPÉCIFICATIONS

	2060 REG	2060 HO	2061 REG	2061 HO
SOURCE LUMINEUSE	12 x LED haute puissance MCPCB		48 x LED puissance moyenne sur MCPCB	
LUMENS RÉELS	982 lm (4000K)	1318 lm (4000K)	687 lm (4000K)	951 lm (4000K)
PUISSANCE TOTALE	15W Totale	22.5W Totale	13.6W Totale	20.8W Totale
OPTIQUES	Angle de faisceau étroit (18°) ou moyen (44°) FWHM			
IRC	85 IRC Typique			
CCT	3000K, 3500K ou 4000K, 3-step MacAdam ellipse binning			
DISTRIBUTION LUMINEUSE	Projecteur directionnel avec pivot 80° et rotation 350°			
MODULE	Reconnu UL - Design propriétaire - Fait aux É-U			
RADIATEUR	Aluminium noir moulé			
VOLTAGE	120V or 277V			
GRADATION	Gradation phase (DP) ou gradation 0-10V (DV)			
GARANTIE	5 ans			