

POINT 2044

PROJECT PROJÉT
SPEC TYPE
NOTES



OVERALL HEIGHT HAUTEUR HORS TOUT

LIGHT SOURCE	LED 8W TRACK 1 CIRCUIT	LED TRACK 1 CIRCUIT	LED *	LED DIM * & 8W 277V *
MOUNTING	2734B	2734E	2401C	2403G
STEM	44.75"	46.45"	43.95"	44.95"

*FOR NO STEM / STEM ≤ 12IN -CANOPY 2401C + ACCESSORY 3983

MOUNTING OPTIONS OPTIONS DE MONTAGE

2734B	2734E	2401C	2403G
1.46" x 1.36" 37 x 35mm	6.15" x 2.00" 156 x 51mm	Ø4.50" x 0.50" Ø114 x 13mm	Ø4.50" x 1.50" Ø114 x 38mm

* OVERALL HEIGHT DOES NOT INCLUDE TRACK THICKNESS

STEM OPTIONS OPTIONS DE TIGE

STEM
STD 36" 914mm

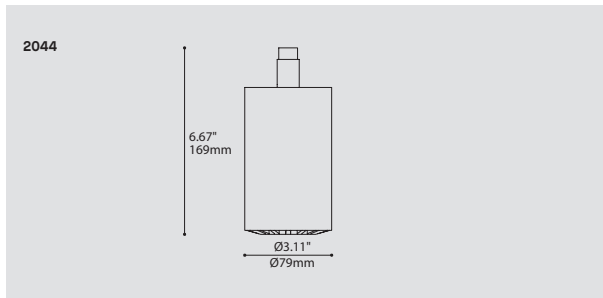

ORDERING SPECIFICATION	SPÉCIFICATION DE COMMANDE	CODE
MODEL MODÈLE		2044
2044	POINT (PROJECTOR HEAD)	
LIGHT SOURCE SOURCE LUMINEUSE		
(WATTAGE, LAMP TYPE, OTHER INFO)		
LED.8	8W, LED	
LED.11	11W, LED	
LED.18	18W, LED	
COLOR TEMPERATURE TEMPÉRATURE DE COULEUR		
30	3000K	
35	3500K	
40	4000K	
ANGLE BEAM ANGLE DE DIFFUSION		
LED.8		
17	17°	
48	48°	
LED.11, LED.18		
20	20°	
40	40°	
VOLTAGE VOLTAGE		
120V	120 VOLT	
277V*	277 VOLT	
	*NOT AVAILABLE WITH A TRACK ADAPTOR	
DIMMING OPTION OPTION DE GRADATION		
DV*	0-10V DIMMING (120-277V)	
DP	PHASE DIMMING (120V ONLY)	
	LED DIMMING DRIVER IS STANDARD FOR 11W & 18W, PLEASE SPECIFY YOUR DIMMING TYPE.	
	*NOT AVAILABLE WITH A TRACK ADAPTOR	
STEM TIGE		
S10	3/8" (10MM) STEM, NOT FIELD ADJUSTABLE	
-	NO STEM	
STEM LENGTH LONGUEUR DE TIGE		
36	36" STEM (STD LENGTH)	
**	CUSTOM STEM LENGTH (PLEASE SPECIFY)*	
	FOR OVERALL LENGTH PLEASE CONTACT YOUR EUREKA REPRESENTATIVE.	
	*3983 ACCESSORY PROVIDED FOR STEM/CABLE ≤ 12", EXCEPT LED 8W 120V NON-DIMMING	
MOUNTING MONTAGE		
RC*	ROUND CANOPY / PAVILLON ROND	
	FOR LED 8W 120V NON-DIMMING & STEM/CABLE ≤ 12": 0.50" CANOPY (2401C)	
	FOR DIMMING LED, LED 8W 277V: 1.75" CANOPY (2403G)	
	*CANOPY FINISH ALWAYS CHROME	
TA1	TRACK ADAPTOR / ADAPTATEUR DE RAIL	
	1 CIRCUIT	
	LED 120V ADAPTOR (2734B) (FOR LED 8W NON-DIMMING ONLY)	
	LED DIMMING 120V ADAPTOR (2734E)	
MOUNTING OPTION OPTION DE MONTAGE		
SCA*	SLOPE CEILING ADAPTOR / ADAPTATEUR DE PLAFOND EN PENTE (ROTATION: 350°, PIVOT: 90°)	
	*ONLY AVAILABLE WITH A STEM	
TRACK ADAPTOR FINISH FINI ADAPTATEUR DE RAIL^(A)		
WH	WHITE	
BLK	BLACK	
M G	METALLIC GRAY (2734B ONLY)	
	^(A) FILL IN IF A TRACK ADAPTOR IS SELECTED, OTHERWISE LEAVE EMPTY	
STRUCTURE FINISH FINI STRUCTURE		CHR
CHR	CHROME	
CYLINDER FINISH FINI CYLINDRE		
BLKA	BLACK ANODIZED	
S A	SATIN ALUMINUM	
WHE	WHITE FINE TEXTURE	
HEATSINK FINISH FINI RADIATEUR		BLKA
BLKA	BLACK ANODIZED	
ACCESSORY ACCESSOIRE		
3983	DEEP JUNCTION BOX (PROVIDED FOR STEM ≤ 12" AS PER ABOVE)	

PRODUCT CHARACTERISTICS CARACTÉRISTIQUES DU PRODUIT



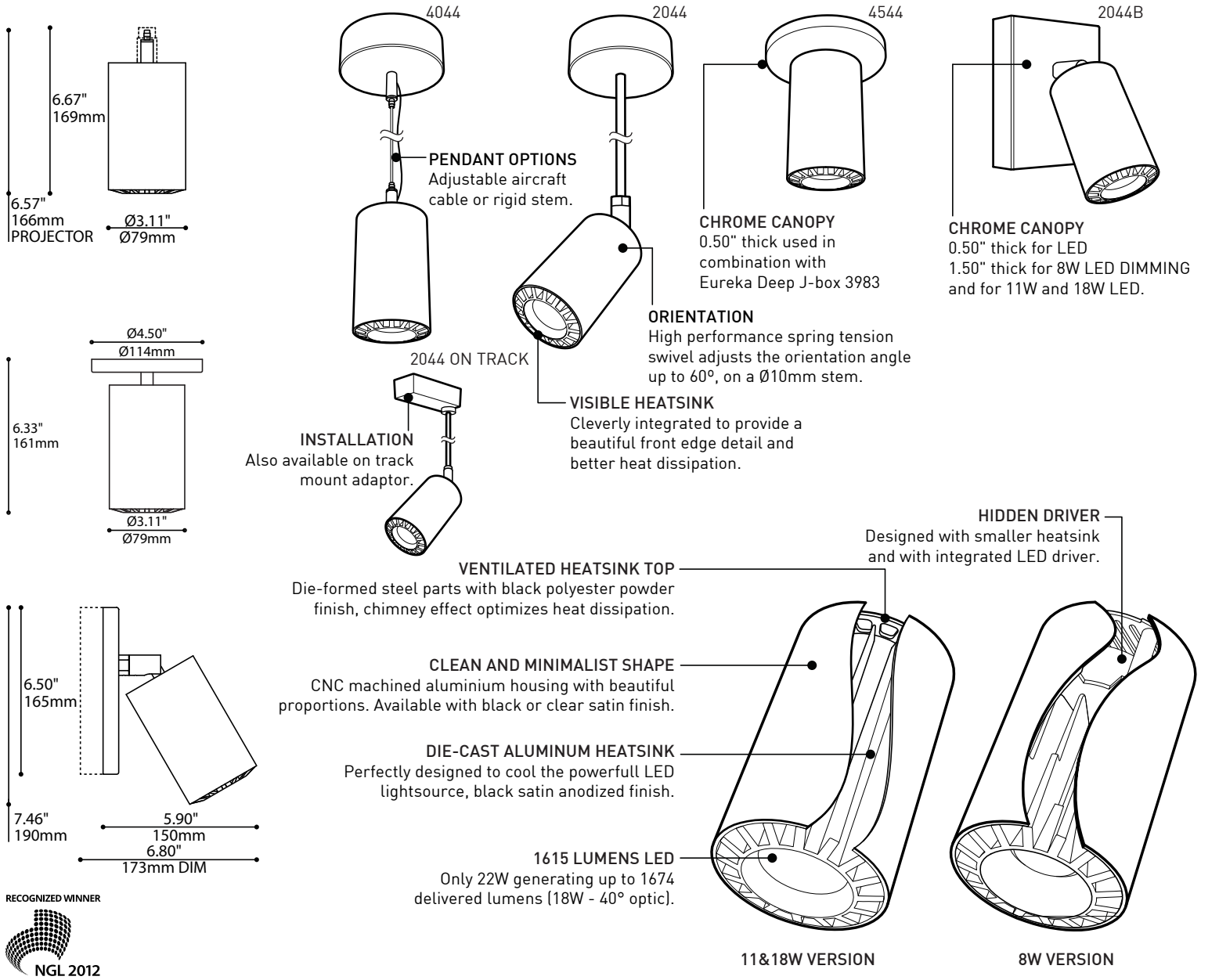

SPECIFICATIONS

	8W LED	11W LED	18W LED
LIGHT SOURCE	4 LED on MCPCB - System wattage 10W Total	1 x COB LED - System wattage 15W Total	1 x COB LED - System wattage 22W Total
DELIVERED LUMENS	964 lm	1438 lm [40° optic] or 1457 lm [20° optic]	1858 lm [40° optic] or 1882 lm [20° optic]
CRI	80 CRI (typical)		
CCT	3-step MacAdam Ellipse binning		
HOUSING	Machined aluminium tube		
HEATSINK	Black anodized aluminum		
LIGHT DISTRIBUTION	Directional (2044/2044B) or Direct (4044/4544)		
OPTICS	Total Internal Reflection (TIR) - 17° & 48°	TIR - 20° & 40°	TIR - 20° & 40°
VOLTAGE	120V or 277V	120V (DP) and 120-277V (DV)	120V (DP) and 120-277V (DV)
DRIVER	Constant Current 700mA, UL Recognized	Constant Current 350mA, UL Recognized	Constant Current 500mA, UL Recognized
DIMMING	Phase Dimming (DP) and 0-10V Dimming (DV)		
LM-79	On request	On request	On request
WARRANTY	5 years		

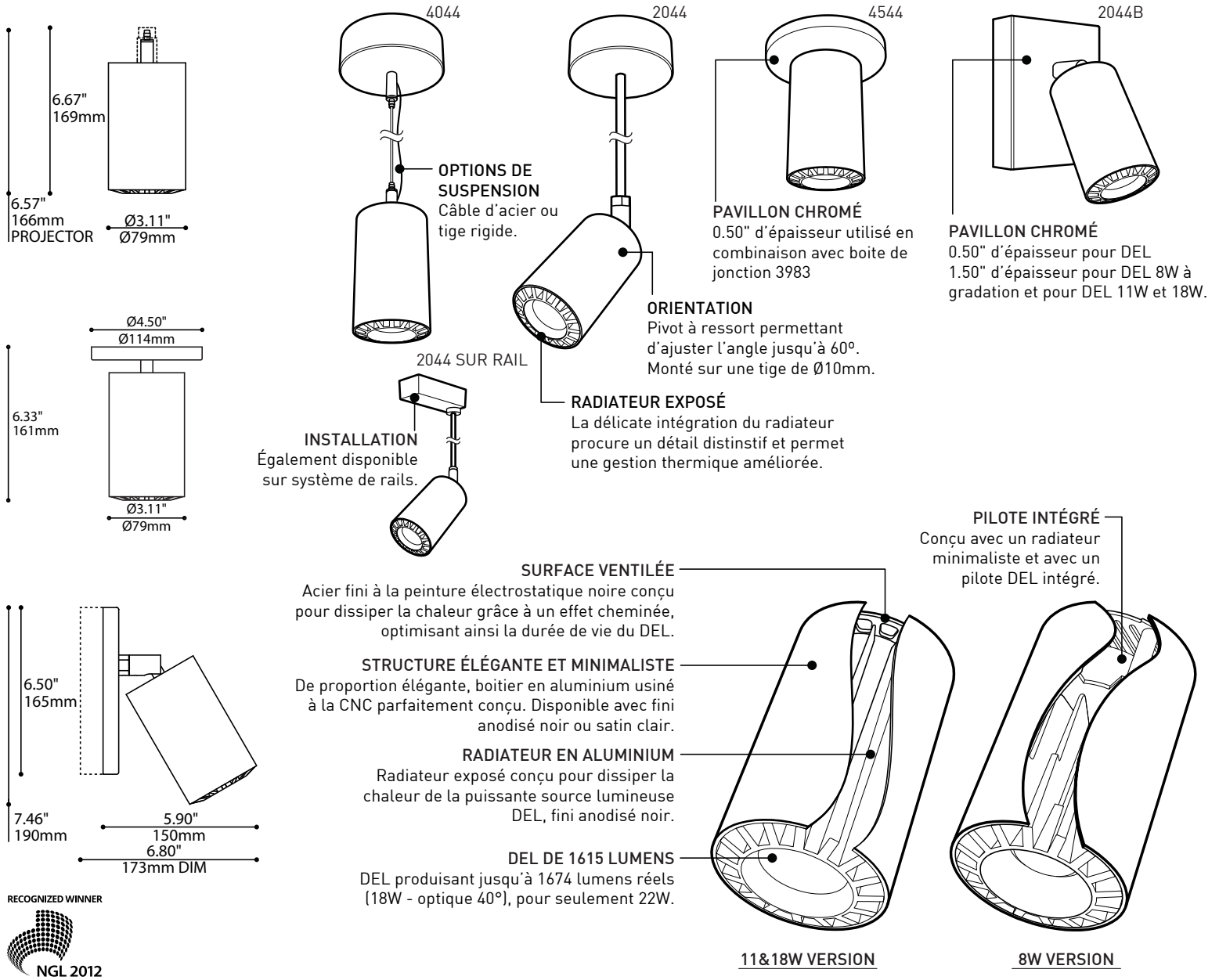

SPECIFICATIONS

SOURCE LUMINEUSE
LUMENS RÉELS

IRC

CCT

BOÎTIER

RADIATEUR

DISTRIBUTION LUMINEUSE

OPTIQUES

VOLTAGE

PILOTE

GRADATION

LM-79

GARANTIE

DEL 8W

4 LED sur MCPCB - Puissance totale de 10W
964lm

80 CRI (typique)

3-step MacAdam Ellipse binning

Tube d'aluminium usiné

Aluminium anodisé noir

Directionnel [2044/2044B] ou direct [4044/4544]

17° & 48° Reflection Totale Interne (TIR)

120V ou 277V

Courant Constant 700mA, Reconnu UL

DP "phase dimming" et DV "0-10V dimming"

Sur demande

5 ans

DEL 11W

1 DEL "COB" - Puissance totale de 15W
1438lm (optique 40°) ou 1457 lm (20°)

Faisceaux de 20° & 40° "TIR"

120V (DP) et 120-277V (DV)

Courant Constant 350mA, Reconnu UL

Sur demande

Sur demande

DEL 18W

1 DEL "COB" - Puissance totale 22W
1858 lm (optique 40°) ou 1882 lm (20°)

Faisceaux de 20° & 40° "TIR"

120V (DP) et 120-277V (DV)

Courant Constant 500mA, Reconnu UL

Sur demande

Sur demande