

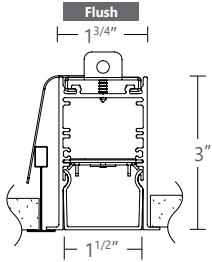

Project \_\_\_\_\_

Type \_\_\_\_\_

Notes \_\_\_\_\_



compatible with  
Armstrong ceiling system



### Ordering Guide

SCRGX		NOM. LUMENS/FT		CRI		COLOR TEMP .		SHIELDING	
PRODUCT ID									
SCR	Sculpt Recessed	300	300 lm/ft - Minimum	80	80 CRI	27	2700 K	FL	flush
		500	500 lm/ft - Maximum	90	90 CRI	30	3000 K		
						35	3500 K		
						40	4000 K		
Outputs between listed min and max are available. Consult factory for outputs outside of the listed range.				Consult Axitune spec sheet for Axis color technology options				All lens options use spotless lens	

GEOMETRIX CEILING KIT (select one)			FINISH	VOLTAGE	DRIVER
Triangle	Parallelogram	Trapeze			
TR75X2	PP75X2	TP75X2	W	120	DP
TR75X4*	PN75X2	TP75X4*	C	277	LT
TR60X2	PP75X4*	TP60X2		347	BI
TR60X4*	PN75X4*	TP45X2		UNV	O
TR45X2	PP60X2				
TR90X2	PN60X2				
TR90X4*	PP60X4*				
TRP904X2	PN60X4*				
TRN904X2	PP45X2				
	PN45X2				

Available as kit; See pages 2-3 for more details;  
\*Only available with the 15/16" Prelude grid system.

(1) Specify system  
(2) Please consult factory; see page 2  
Consult Axitune spec sheet for Axis color driver options

CIRCUITS	MOUNTING	BATTERY (OPTIONAL)	OTHER (OPTIONAL)	IC CONTROL (OPTIONAL)	CUSTOM
1 1 circuit 2 2 circuits +E(#) emergency section (3) +NL(#) night light section (3) +GTD(#) generator transfer device (3)	MFTB15 MiniFlange t-bar 15/16" * MFTG9 MiniFlange 9/16" t-tegular *	B# battery pack 4' sections	F fuse (4) FW(#) flex whip (6' std) CP Chicago plenum	DS# daylight sensor (5) OS# occupancy sensor (5) DOS# daylight & occupancy sensor (5) EN# enlightened integral (5) ENR# enlightened remote (6) WC# wireless control dimming	C custom
3) Specify quantity	* See page 6 for Armstrong ceiling compatibility.	Not available with 347V Please consult factory	(4) Requires 120V or 277V	(5) For flush option only; Please consult factory (6) Please consult factory Specify quantity. Requires 7" blank See integrated controls guide for more details.	Please specify

### ● SCULPT GEOMETRIX FORM OPTIONS

75°

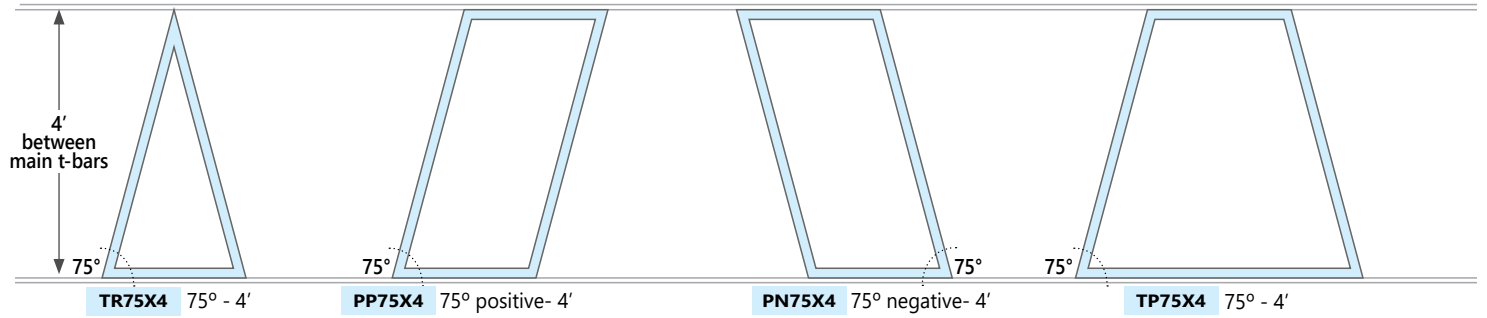
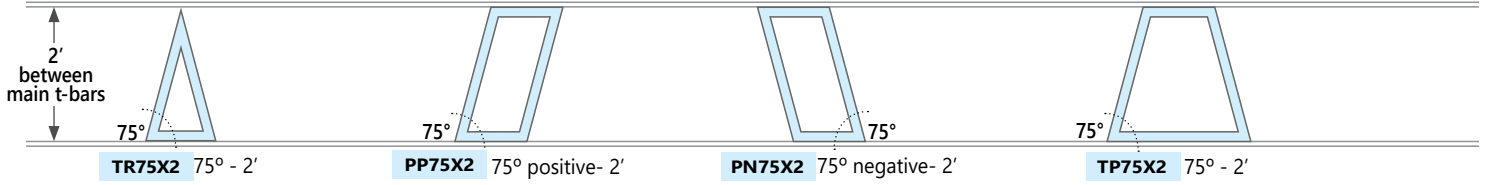

60°

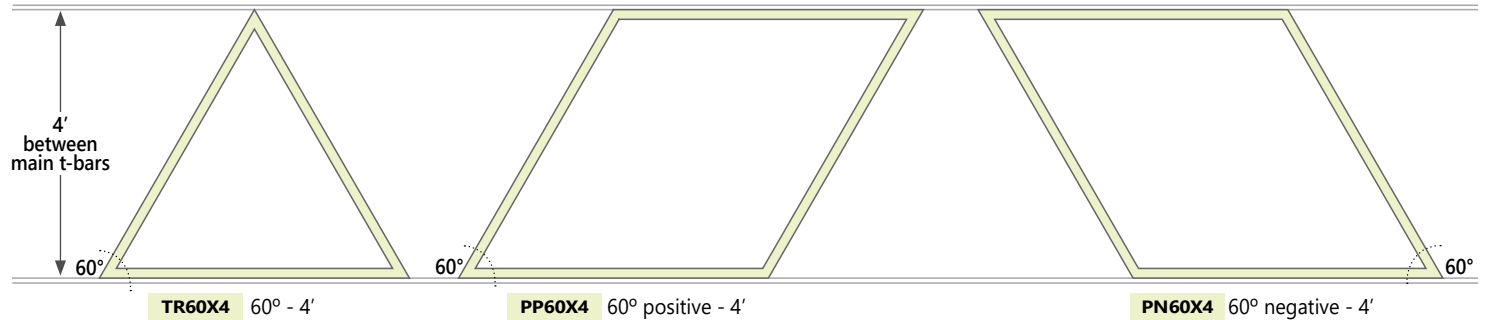
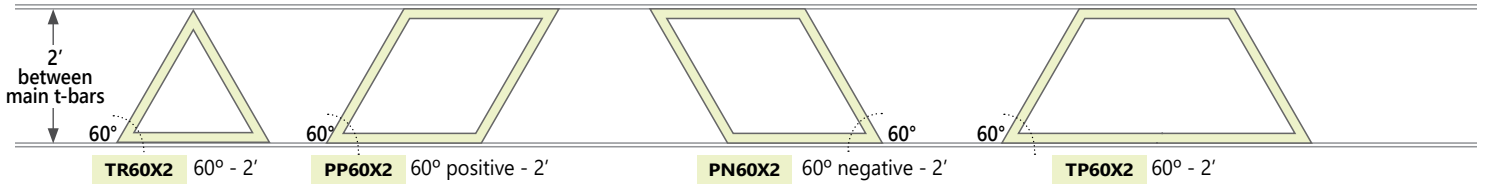

### 45°

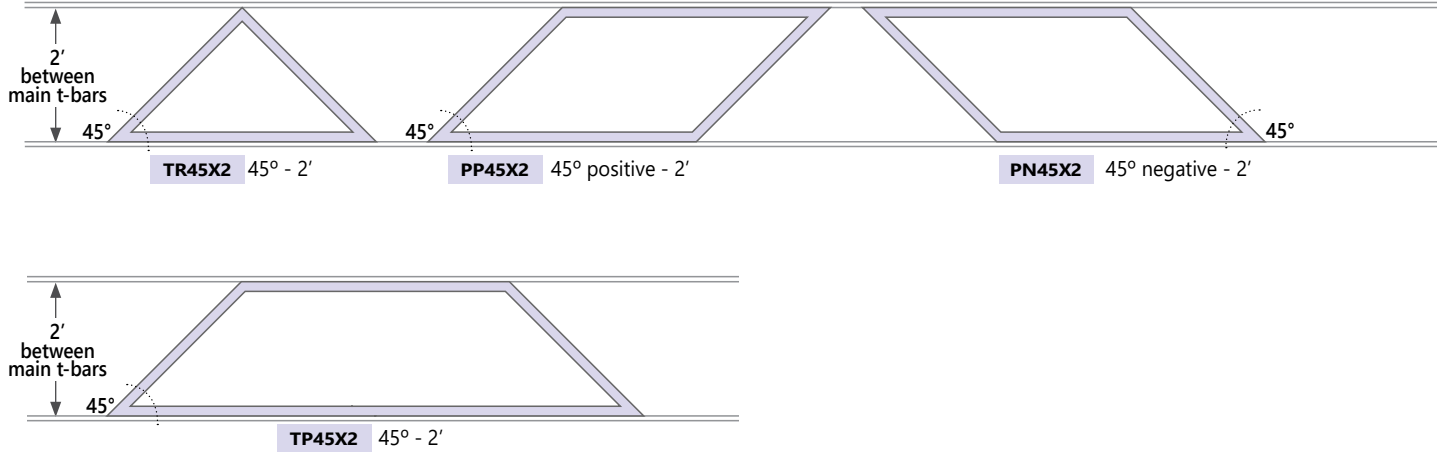

### 90° Right Triangles

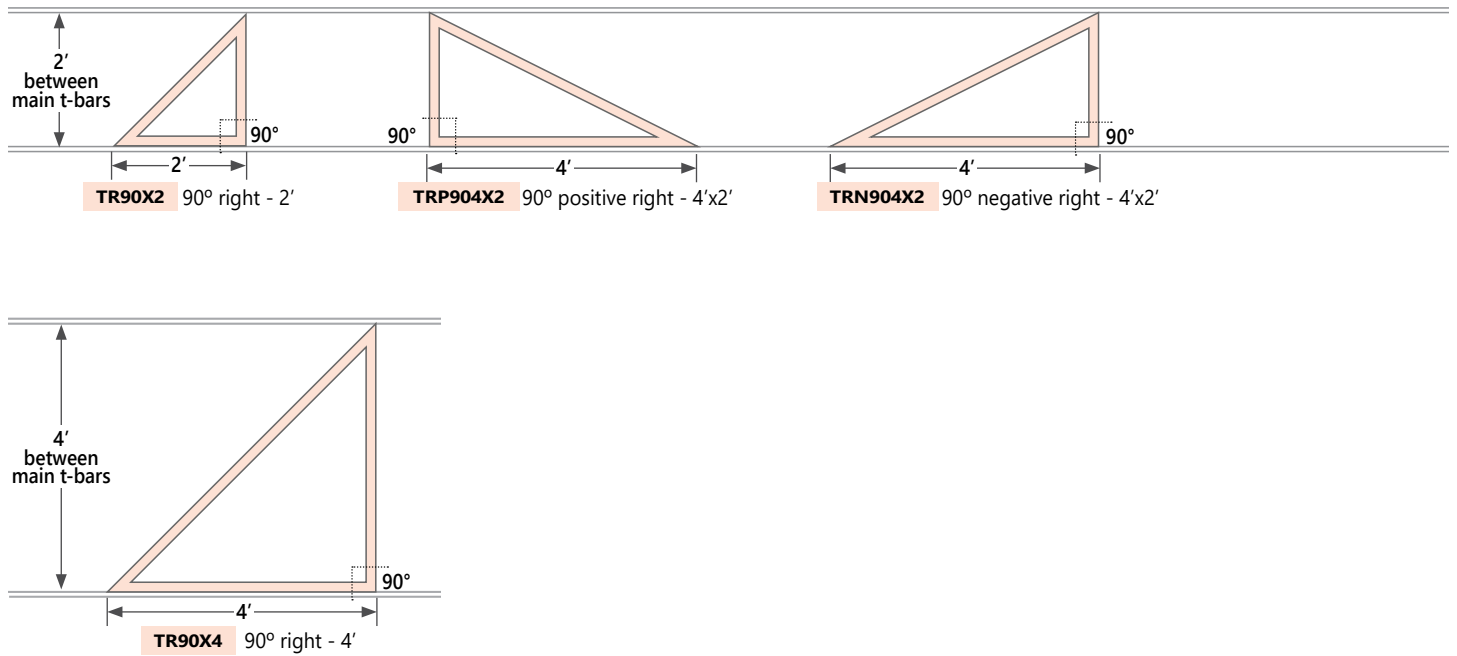

# Geometrix



## Uniquely shaped lighting elements for creative ceiling designs

Enjoy freedom from traditional ceiling footprints with a recessed family of 23 precision-tooled triangles, parallelograms and trapezoids. Discover new and exciting opportunities above and beyond the norm for architectural ceilings, brought to you by industry leaders Axis Lighting and Armstrong Ceiling Solutions.

### Geometric Lighting Benefits

- Visually comfortable and esthetically pleasing traces of light.
- Seamless integration with DESIGNFlex™ by Armstrong.
- Easy installation – DESIGNFlex features pre-cut tile inserts.
- Ceiling kits include all the required lightingware and hardware.

An exclusive palette of non-rectangular recessed lighting elements compatible with Armstrong DESIGNFlex Ceiling System.

**75°**

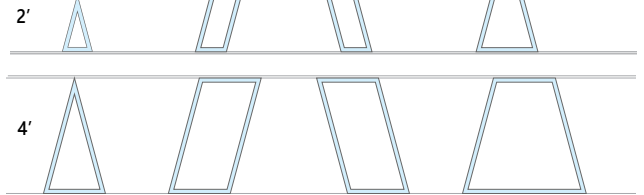

**60°**

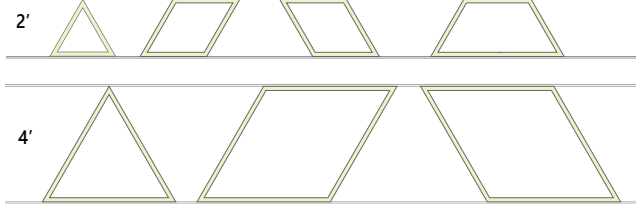

**45°**

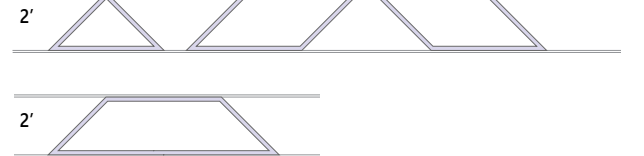

**90° Right Triangles**

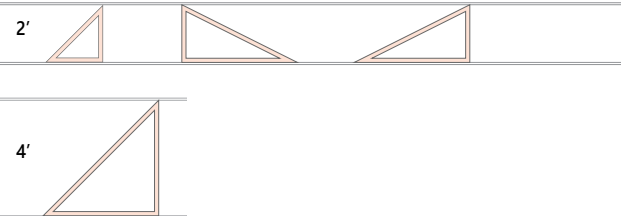

● **LED SYSTEM**

- CRI** Minimum 80 or 90 color rendering index
- CCT** Choice of 3000K, 3500K and 4000K color temperature with a great color consistency (within 3.0-step MacAdam ellipse).
- LED life** Minimum 50,000h with 85% of lumen maintenance in 25°C ambient temperature, in compliance with IES LM-80 testing measurements.
- Thermal Management** Aluminum housing acting as the heat sink to maximize life.

● **CONSTRUCTION**

- Housing** Extruded aluminum (0.080" nominal) up to
- End Cap** Die cast aluminum
- Interior Brackets** Die formed sheet steel (20 gauge)
- Lenses** Extruded acrylic (0.060" nominal) - injection moulded
- Hanger** Die cast aluminum
- Suspension** Sliding aircraft cable along product length
- Cable Grips** Quick connecting / release

● **ELECTRICAL**

- Lutron driver\*** LDE1 - EcoSystem H-Series (1%)  
 LDE5 - EcoSystem 5-Series (5%)  
 LTE - Hi-Lume® A-series 2Wires Forward Phase (1%)  
 \*Consult factory
- Other drivers** DALI - Digital Addressable Lighting Interface  
 DMX - Digital Multiplex  
 LV - line voltage - Advance Mark 10  
 Xitanium SR - For wireless sensor
- Emergency** Integral emergency battery pack or emergency circuit optional.
- Input Voltage** 120V, 277V, 347V, UNV.

**i** Incorporating these components may have limitations or affect the length of the luminaire. Please contact factory for more details.

● **WARRANTY**

Axis lighting will warrant defective LEDs, boards, and drivers for 5 years from date of purchase. Warranty is valid if luminaire is installed and used according to specifications. If defective, Axis will send replacement boards or drivers at no cost along with detailed replacement instructions and instructions on how to return defective components to Axis.

● **SHIELDING** - Frosted acrylic Spotless lens

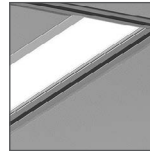

**FL** flush

● **FINISH**

Powder coated and custom finishes are also available.

● **APPROVALS**

Certified to UL and CSA standards   
 Meets CCEC requirements (Chicago plenum)  
 Suitable for damp locations.  
 IC Rated (Insulated ceiling)

● KIT AND LINEAR - WITH INTEGRATED MINIFLANGE

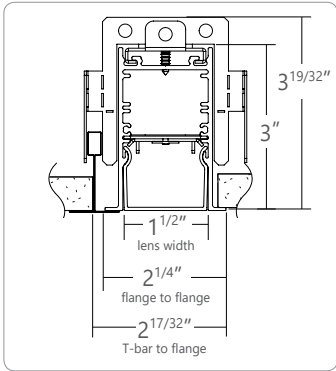

**MFTB15 MiniFlange 15/16\"TBAR**

**Prelude ceiling system by  
Armstrong**

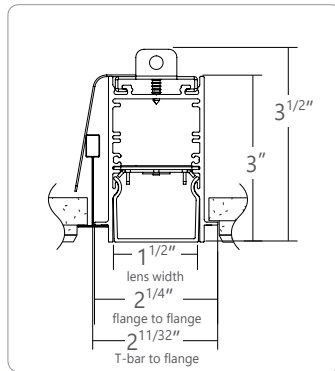

**MFTG9 MiniFlange 9/16\"TREGULAR**

**Suprafine ceiling system by  
Armstrong**

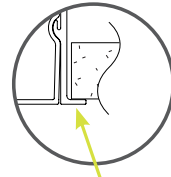

**MiniFlange**

### Integrated MiniFlange (patent pending)

When installed along T-bars in acoustic ceilings, the Integrated MiniFlange supports adjacent ceiling tiles. At the same time, it **eliminates the need for a second T-bar**. This feature comes standard on Sculpt Recessed.

- Fewer materials needed and less labor.
- Conceals ceiling tile cutline for a cleaner appearance.
- Simplifies drawings and trade coordination.
- Available in different T-bar profiles.

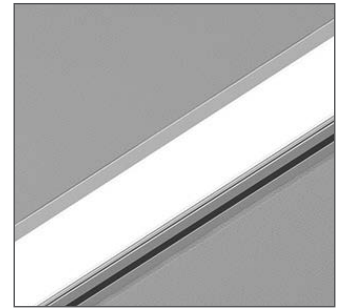

**With Integrated MiniFlange**