

Edge 2 Direct

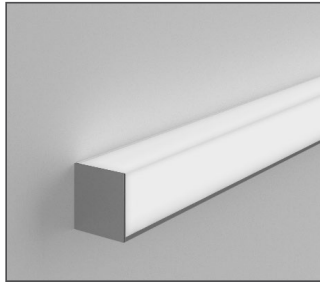

Edge 2 Indirect

Project _____

Type _____

Notes _____

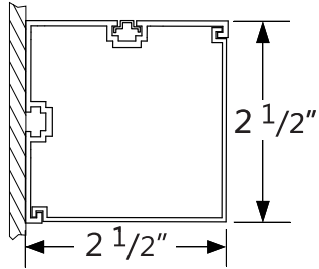

Direct

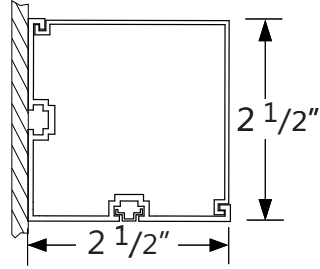

Indirect



CONTROL
SENSORS

Ordering Guide

EDW2		NOM. LUMENS/FT		CRI	COLOR TEMP.	SHIELDING	LENGTH	FINISH	
PRODUCT ID									
ED2WD	Edge 2 Wall Direct LED	250	250 lm/ft	80	80 CRI	27	2700 K	UB	Ultra Blend Lens
ED2WI	Edge 2 Wall Indirect LED	500	500 lm/ft	90	90 CRI	30	3000 K		
		850	850 lm/ft			35	3500 K		
		1000	1000 lm/ft			40	4000 K		
Outputs between listed min and max are available. Consult factory for outputs outside of the listed range.							Comes in 1ft increments. For all other lengths and related outputs, please consult factory.		

GROOVE FINISH	VOLTAGE	DRIVER	CIRCUITS
AP aluminum paint	120 120 V	MD Mini driver - integral*	1 1 circuit
W white	277 277 V	DP dimming (0-10V) 1% - remote**	2 2 circuits
BLK black	347 347 V	LT Lutron-remote ⁽¹⁾ - remote**	+E(#) emergency circuit ⁽³⁾
C custom	UNV universal	BI bi-level dimming - remote**	
		O other ⁽¹⁾ - remote**	
*Integral driver ** Remote driver (1) Specify system. Remote only. (2) Please consult factory; see page 2			(3) Specify quantity

END CAP	BATTERY - REMOTE (OPTIONAL)	OTHER (OPTIONAL)	IC CONTROLS (OPTIONAL)	CUSTOM (OPTIONAL)
FL flat standard	B# remote battery pack	F fuse	DS# daylight sensor OS# occupancy sensor DOS# daylight & occupancy sensor EN# Enlighted integral ⁽⁴⁾ ENR# Enlighted remote ⁽⁴⁾ WC# wireless control dimming	C custom
For close end cap only	Remote only	Requires 120V or 277V	(4) Please consult factory Specify quantity. Requires 8" blank See pages 5-6 for more details	Please specify

● SPECIFICATIONS

CONSTRUCTION

Housing	Extruded aluminum (0.075" nominal) Up to 70% recycled content
End Cap	Cast aluminum
Interior Brackets	Die formed sheet steel (20 gauge)
Reflectors	White powder coated sheet steel (22 gauge)
Lenses	Extruded acrylic (0.070" nominal)

● OPTICS

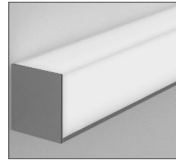

UB Ultra Blend Lens

● ELECTRICAL

Mini driver	EDGE 2 features integral mini driver technology. 0-10V dimming standard.
Emergency	Remote emergency battery pack or emergency circuit optional.
Input Voltage	120V, 277V, 347V, UNV.

i Incorporating these components may have limitations or effect the length of the luminaire, please contact factory for more details.

● LED SYSTEM

CRI	Minimum 80 or 90 color rendering index.
CCT	Choice of 2700K, 3000K, 3500K and 4000K color temperature with a great color consistency (within 3-step MacAdam ellipse). Both within fixture and fixture to fixture.
LED life	Minimum 50,000h with 85% of lumen maintenance in 25°C ambient temperature, in compliance with IES LM-80 testing measurements.
Thermal Management	Aluminum housing acting as the heat sink to maximize life.
Environment	Dry and damp rated in operating ambient temperatures of 0-40°C (32-104F).

● SYSTEM (S#)

EDGE 2 linear systems, with the use of a strong profile, allow for a nearly hair thin connection system of continuous runs. Lengths of 4', 8', 12' as well as custom lengths are available. Runs of EDGE 2 that are greater than 12' in length are designated as systems (S#). This means that the run is comprised of a combination of 4', 8' and/or 12' sections to be assembled on site using our joining system. For more information on systems and joining, please refer to the EDGE 2 installation sheets available for download at www.axislighting.com.

● WARRANTY

Axis Lighting will warrant defective LEDs, boards, and drivers for 5 years from date of purchase. Warranty is valid if luminaire is installed and used according to specifications. If defective, Axis will send replacement boards or drivers at no cost along with detailed replacement instructions and instructions on how to return defective components to Axis.

● MOUNTING SPACING

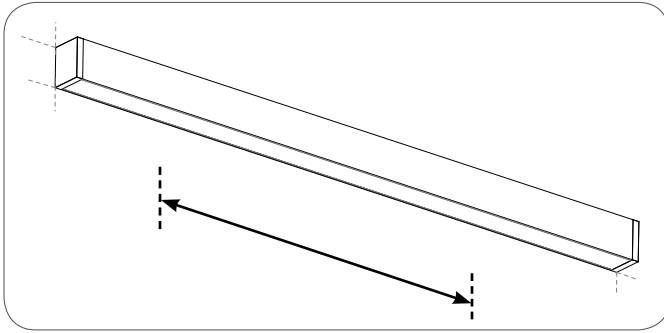

EDGE 2 LED 4' (32" C.C.)
 EDGE 2 LED 8' (80" C.C.)
 EDGE 2 LED 12' (128" C.C.)

NOTE: Use stud if possible for mounting

● HORIZONTAL MOUNTING DETAILS

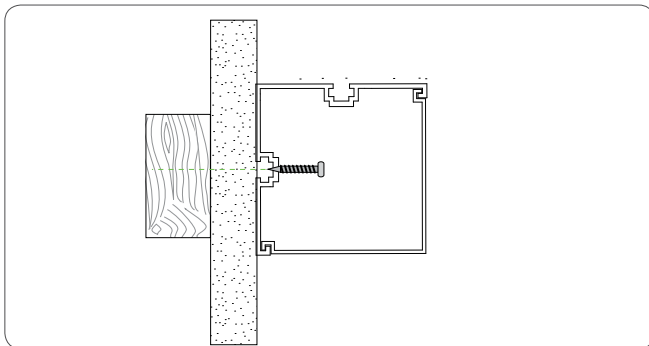
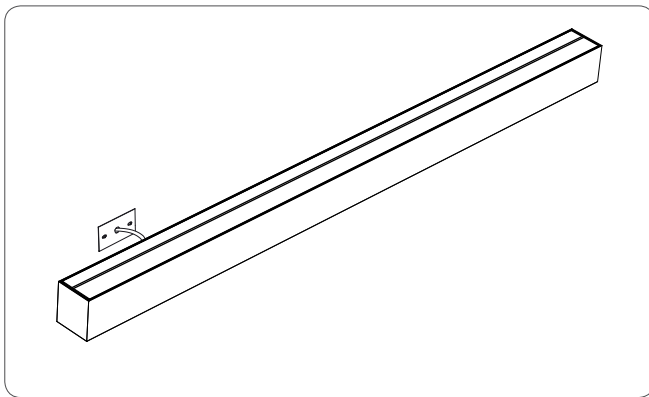

SIDE VIEW

● VERTICAL MOUNTING DETAILS

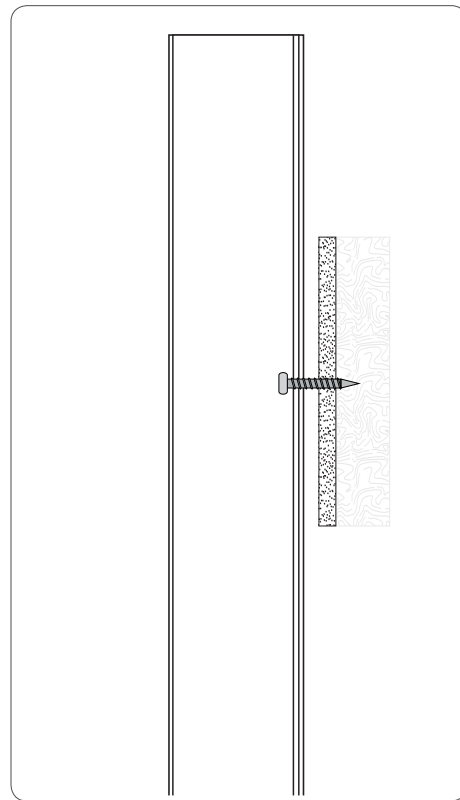

SIDE VIEW

● OTHER MOUNTING OPTIONS

EDGE 2 is also available as Pendant or Surface.

i Specification sheets and installation sheets for all mountings for EDGE 2 luminaires are available for download at www.axislighting.com

● PHOTOMETRIC DATA

Indirect - 1000 lm/ft

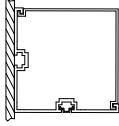

PHOTOMETRIC CURVE

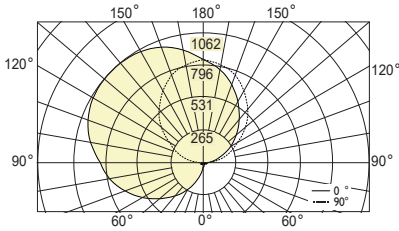

Lumen/ft: 1000 lm/ft
Total Lumens: 4211 lm (for 4ft)
Input Watts: 32.2 W
Efficacy: 131 lm/W

IES FILE: ED2WI-UB-1000-80-35-4.IES

TESTED ACCORDING TO IES LM-79-2008

80 CRI shown. To calculate watts and efficacy at 90 CRI, apply a multiplier of 0.8.

CANDELA DISTRIBUTION

Vertical Angle	Horizontal Angles				
	0	22.5	45	67.5	90
0	32	32	32	32	32
5	28	27	27	27	29
15	20	18	17	18	22
25	13	9	7	9	14
35	7	4	3	2	7
45	18	4	3	1	0
55	14	4	3	2	7
65	17	4	3	2	14
75	29	3	4	6	22
85	18	7	7	12	29
90	2	21	18	15	32
95	55	44	38	33	36
105	164	123	108	101	105
115	266	226	211	198	196
125	380	341	313	299	297
135	510	458	423	401	399
145	614	567	539	510	510
155	718	675	646	621	624
165	795	761	737	725	730
175	830	819	812	810	813
180	843	843	843	843	843

ZONAL LUMENS

Zone	Lumens
0	
0-10	3
10-20	12
20-30	29
30-40	56
40-50	92
50-60	135
60-70	181
70-80	224
80-90	257
90-100	306
100-110	382
110-120	449
120-130	486
130-140	487
140-150	444
150-160	358
160-170	232
180	80

LUMINANCE DATA (cd/m²)

Vertical Angle	Horizontal Angles		
	0	45	90
45	343	34	0
55	336	40	88
65	515	53	191
75	1397	74	324
85	2144	158	514