



# RECESSED VERTICAL MOUNT

## PROJECT INFORMATION

Project:

Type:

Notes:

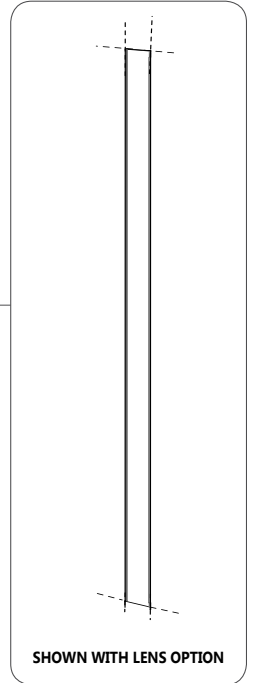

## DIMENSIONS

SECTION VIEW

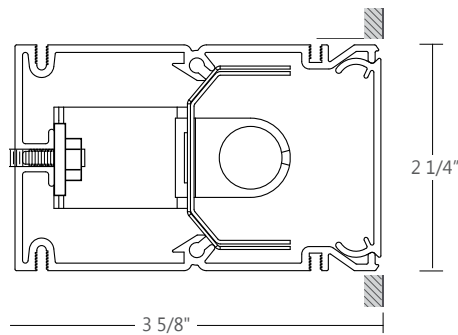

cULus Listed  
Type I.C.

## ORDERING CODE

1	2	3	4	5	6	7	8	9	10	11	12	13	14
---	---	---	---	---	---	---	---	---	----	----	----	----	----

## PRODUCT SPECIFICATIONS

1 PRODUCT ID	2 OPTICS	3 LENGTH (FT)	4 SPECIFY LENGTH	5 LAMP	6 LAMP CONFIGURATION
<b>BRV</b> recessed vertical	<b>S</b> satin lens <b>F</b> frosted lens <sup>(1)</sup>	<b>2</b> 2' <b>3</b> 3' <b>4</b> 4' <b>5</b> 5' <b>6</b> 6' <b>8</b> 8' <b>12</b> 12' <b>S#</b> System Run	<b>NL</b> nominal (3' & 4' lamps) <b>NL4</b> nominal (4' lamps only) <b>EX</b> exact (3' & 4' lamps) <b>EX4</b> exact (4' lamps only)	<b>T5</b> T5 <b>T5HO</b> T5HO <b>T8</b> T8	<b>1</b> 1 lamp <b>+S</b> staggered <sup>(2)</sup>
	(1) not recommended with staggered lamping				(2) Not available with T8 lamping.

7 FINISH	8 VOLTAGE	9 BALLAST	10 CIRCUITS	11 MOUNTING	12 BATTERY (OPTIONAL)
<b>W</b> white <b>C</b> custom	<b>120</b> 120 V <b>277</b> 277 V <b>347</b> 347 V <sup>(3)</sup> <b>UNV</b> universal	<b>D</b> dimming <b>E</b> instant start <sup>(4)</sup> <b>ERS</b> program start <b>BI</b> bi-level dimming	<b>1</b> 1 regular <b>2A/B</b> 2 alternating <b>+E(#)</b> emergency section <b>+NL(#)</b> night light section <b>+GTD(#)</b> generator transfer device	<b>DF</b> drywall flange <b>DS</b> drywall spackle flange <b>D</b> drywall flangeless	<b>B#</b> battery pack 4' sections
	(3) Please consult factory	(4) Available with T8 lamp only			Requires 120V or 277V

13 OTHER (OPTIONAL)	14 CUSTOM (OPTIONAL)
<b>F</b> fuse <b>EF</b> end feed <b>CP</b> Chicago plenum	<b>C</b> custom
	Please specify



## ● CONSTRUCTION

<b>Housing</b>	Extruded Aluminum (0.075" nominal) up to 70% Recycled Content
<b>Interior Brackets</b>	Die Formed Sheet Steel (18 gauge)
<b>Reflectors</b>	White Powder Coated Sheet Steel (22 ga)
<b>Blank</b>	Extruded Aluminum (0.075" nominal)
<b>Lenses</b>	Extruded Acrylic (0.070" nominal) Satin: 68% efficiency Frosted: 85% efficiency
<b>Hanger</b>	Die Formed Sheet Steel (16 gauge)
<b>Suspension</b>	Aircraft Cable or Ø 1/2" Stem
<b>Cable Grips</b>	Quick Connecting / Release

## ● WEIGHT

<b>4 ft</b>	10.5 lbs / 4.8 kg
<b>8 ft</b>	21.0 lbs / 9.6 kg
<b>12 ft</b>	31.5 lbs / 14.4 kg

## ● SYSTEM (S#)

BEAM 2 linear systems, with the use of a strong profile, allow for a nearly hair thin connection system of continuous runs. Lengths of 4', 8', 12' as well as custom lengths are available. Runs of BEAM 2 that are greater than 12ft in length are designated as systems (S#). This means that the run is comprised of a combination 4ft, 8ft and/or 12ft sections to be assembled on site using our joining system. For more information on systems and joining, please refer to the BEAM installation sheets available for download at [www.axislighting.com](http://www.axislighting.com).

## ● ELECTRICAL

<b>Ballast</b>	Electronic IS, Electronic Rapid Start, Dimming (0-10V, Line, EcoSystem, DALI), BI-level dimming With preinstalled ballast disconnect as per NEC & CEC
<b>Emergency</b>	Emergency battery pack or emergency circuit
<b>Voltage</b>	120V, 277V, 347V, UNV

**i** Incorporating these components may have limitations or effect the length of the luminaire, please contact factory for more details.

## ● FINISH

Aluminium paint, Powder Coated and custom finishes are also available.

## ● APPROVALS

Certified to UL and CUL standards   
 Meets NYC requirements  
 Meets CCEC requirements (Chicago plenum)  
 Suitable for damp locations.  
 IC Rated (Insulated ceiling)

## ● JOINERS

In order to allow very long runs of BEAM 2 luminaires, Axis has developed an effective joining system. Special care has been taken to maximize the performance of the joiner for each BEAM option.

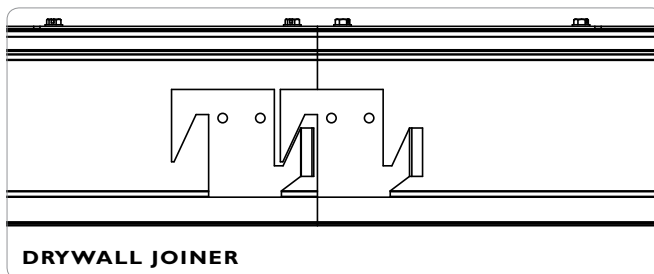
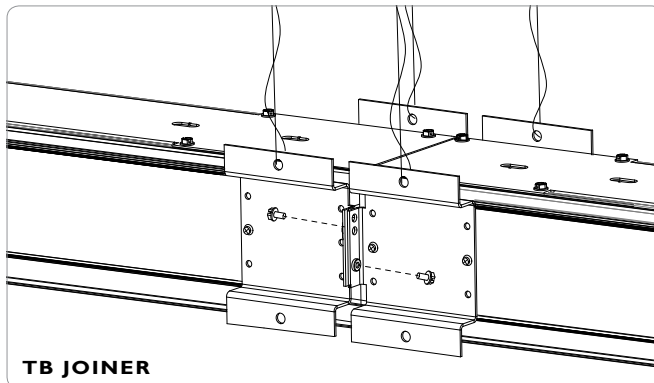

**NOTE:** Mount each system segment individually. Do not assemble system prior to hanging.

## ● STAGGERED LAMPING

When BEAM 2 is used in continuous runs longer than 4', staggered lamping can be used to eliminate the appearance of socket shadows at the ends of the lamps. BEAM 2 uses a staggered overlap of bracket lengths (4"), along with 3' and 4' lamps, allowing us to match almost any row length requirements with optimal results. For example 3 x 3' staggered T5 lamps can be used to completely illuminate the lens of an 8' nominal luminaire.

LAMP TYPE	T5	T5HO
1 lamp	●	●

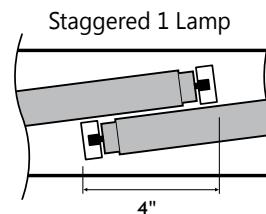

● **OPTICS**

**Satin & Frosted Lens - (acrylic snap-in lens)**

satin: 68% trans.

frosted: 85% trans.

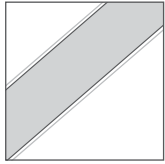

**S** satin lens

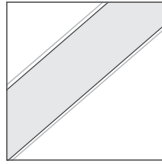

**F** frosted lens

● **OTHER MOUNTING OPTIONS**

BEAM 2 is also available with recessed, pendant, surface, wall, and asymmetric mounted options.

**i** Specification sheets and Installation sheets for all mounting for BEAM luminaires are available for download at [www.axislighting.com](http://www.axislighting.com)

● **VERTICAL RECESSED MOUNTING OPTIONS**

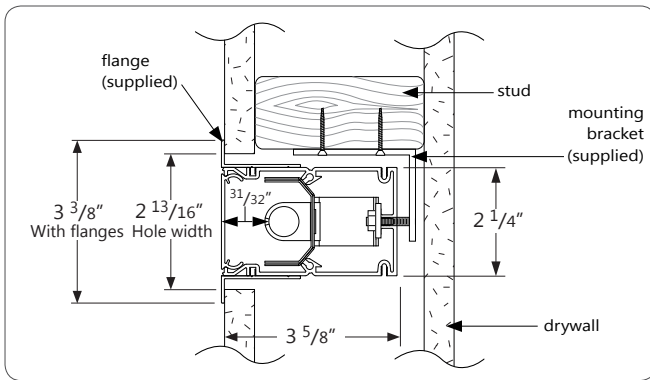

**DF** DRYWALL FLANGED

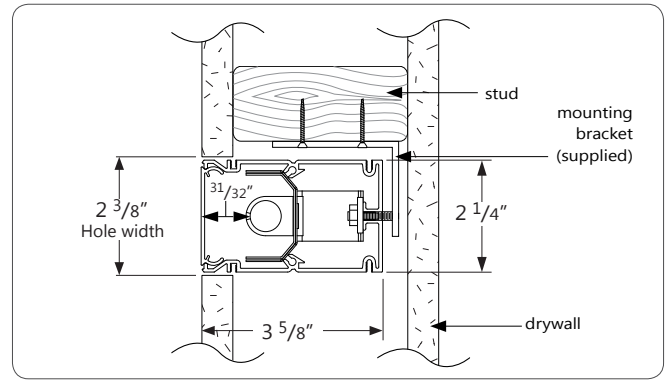

**D** DRYWALL FLANGELESS

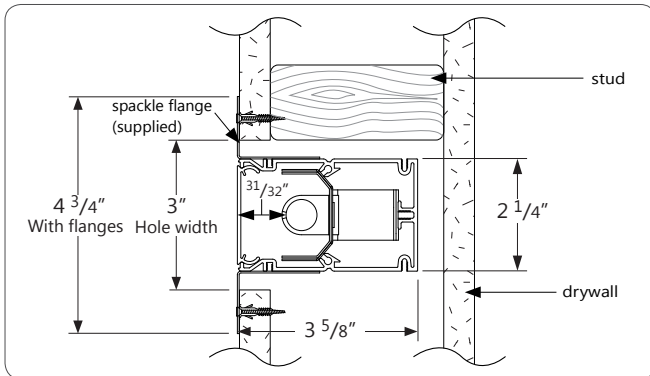

**DS** DRYWALL SPACKLE FLANGE

● **PHOTOMETRIC DATA**

**I T5**

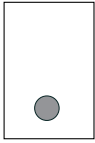

**PHOTOMETRIC CURVE**

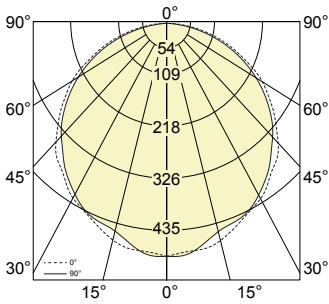

**Test Lamp: 1xF28T5**  
 IES FILE: BDR-S-4-T5-1

**Efficiency: 47.2%**

**CANDELA DISTRIBUTION**

Vertical Angle	Horizontal Angles					Zonal Lumens
	0	22.5	45	67.5	90	
0	486	486	486	486	486	
5	478	481	490	472	484	26
15	462	458	454	457	444	109
25	424	427	423	415	421	180
35	380	380	376	369	370	228
45	325	322	310	313	312	244
55	256	253	248	250	244	231
65	179	177	173	170	169	187
75	102	98	94	91	90	119
85	31	27	23	20	18	44
90	6	3	1	0	0	

**LUMINANCE DATA (CD/M<sup>2</sup>)**

Vertical Angle	Horizontal Angles		
	0	45	90
45	6157	2892	2443
55	5808	2314	1866
65	5252	1662	1296
75	4411	961	716
85	2745	255	157

**COEFFICIENTS OF UTILIZATION (%)**

Ceiling	80			70			50				
	70	50	30	10	70	50	30	10	50	30	10
Wall	70	50	30	10	70	50	30	10	50	30	10
0	56	56	56	56	55	55	55	55	53	53	53
1	51	49	47	45	50	48	46	44	46	44	43
2	47	43	39	37	45	42	39	36	40	38	35
3	43	37	34	30	41	37	33	30	35	32	30
4	39	33	29	26	38	33	29	26	31	28	25
5	36	30	25	22	35	29	25	22	28	24	22
6	33	27	22	19	32	26	22	19	25	22	19
7	31	24	20	17	30	24	20	17	23	19	17
8	28	22	18	15	28	22	18	15	21	18	15
9	27	20	16	14	26	20	16	14	19	16	14
10	25	19	15	12	24	18	15	12	18	15	12

Based on floor reflectance of 20

**I T5**

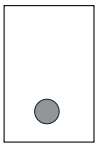

**PHOTOMETRIC CURVE**

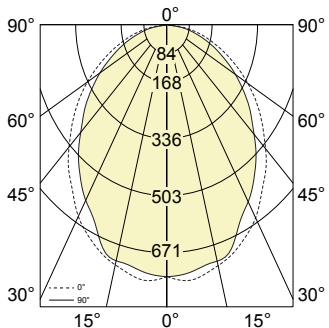

**Test Lamp: 1xF28T5**  
 IES FILE: BDR-F-4-T5-1

**Efficiency: 55.7%**

**CANDELA DISTRIBUTION**

Vertical Angle	Horizontal Angles					Zonal Lumens
	0	22.5	45	67.5	90	
0	737	737	737	737	737	
5	750	739	729	755	728	40
15	702	689	675	676	692	166
25	616	598	585	576	564	256
35	504	495	474	453	452	295
45	389	375	355	340	339	285
55	281	268	255	238	237	242
65	180	175	161	152	149	179
75	100	94	86	80	77	109
85	32	28	23	19	18	42
90	5	4	1	0	1	

**LUMINANCE DATA (CD/M<sup>2</sup>)**

Vertical Angle	Horizontal Angles		
	0	45	90
45	7363	3305	2651
55	6363	2373	1811
65	5285	1547	1141
75	4328	882	617
85	2808	257	150

**COEFFICIENTS OF UTILIZATION (%)**

Ceiling	80			70			50				
	70	50	30	10	70	50	30	10	50	30	10
Wall	70	50	30	10	70	50	30	10	50	30	10
0	67	67	67	67	65	65	65	65	62	62	62
1	61	59	56	54	60	57	55	54	55	53	52
2	56	52	48	45	55	51	47	45	49	46	44
3	51	46	42	38	50	45	41	38	43	40	37
4	47	41	36	33	46	40	36	33	39	35	32
5	44	37	32	29	43	36	32	28	35	31	28
6	41	33	29	25	40	33	28	25	32	28	25
7	38	31	26	23	37	30	26	22	29	25	22
8	35	28	23	20	34	28	23	20	27	23	20
9	33	26	21	18	32	25	21	18	25	21	18
10	31	24	20	17	30	24	20	17	23	19	17

Based on floor reflectance of 20

**i** All IES files for other lamping are available for download at: [www.axislighting.com](http://www.axislighting.com)

**PHOTOMETRIC DATA**

**I T5HO**

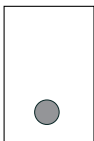

**PHOTOMETRIC CURVE**

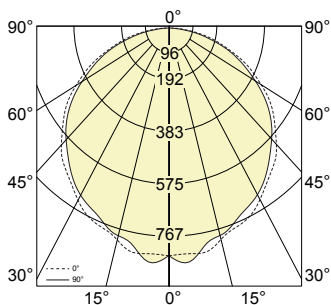

**Test Lamp: IxF54T5HO**  
 IES FILE: BDR-S-4-T5HO-1

**Efficiency: 47.2%**

**CANDELA DISTRIBUTION**

Vertical Angle	Horizontal Angles					Zonal Lumens
	0	22.5	45	67.5	90	
0	837	837	837	837	837	
5	833	819	815	834	863	45
15	790	789	787	785	781	189
25	740	736	735	715	712	311
35	651	653	644	641	631	391
45	554	557	540	533	534	420
55	445	437	430	426	420	399
65	311	307	300	294	289	322
75	174	169	163	158	155	206
85	52	47	40	32	32	76
90	10	6	2	1	1	

**COEFFICIENTS OF UTILIZATION (%)**

Ceiling	80			70			50				
	70	50	30	10	70	50	30	10	50	30	10
Wall	70	50	30	10	70	50	30	10	50	30	10
0	56	56	56	56	55	55	55	55	53	53	53
1	51	49	47	45	50	48	46	44	46	44	43
2	47	43	39	37	45	42	39	36	40	38	35
3	43	37	34	30	41	37	33	30	35	32	30
4	39	33	29	26	38	32	29	26	31	28	25
5	36	30	25	22	35	29	25	22	28	24	22
6	33	27	22	19	32	26	22	19	25	22	19
7	31	24	20	17	30	24	20	17	23	19	17
8	28	22	18	15	28	22	18	15	21	18	15
9	27	20	16	14	26	20	16	14	19	16	14
10	25	19	15	12	24	18	15	12	18	15	12

Based on floor reflectance of 20

**LUMINANCE DATA (CD/M<sup>2</sup>)**

Vertical Angle	Horizontal Angles		
	0	45	90
45	10496	5026	4183
55	10082	4004	3204
65	9116	2879	2216
75	7542	1674	1233
85	4565	450	276

**I T5HO**

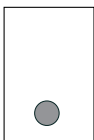

**PHOTOMETRIC CURVE**

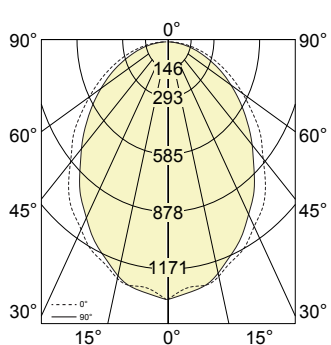

**Test Lamp: IxF54T5HO**  
 IES FILE: BDR-F-4-T5HO-1

**Efficiency: 55.7%**

**CANDELA DISTRIBUTION**

Vertical Angle	Horizontal Angles					Zonal Lumens
	0	22.5	45	67.5	90	
0	1317	1317	1317	1317	1317	
5	1254	1247	1232	1223	1246	69
15	1129	1127	1115	1098	1079	285
25	974	940	915	882	883	443
35	756	744	716	679	669	507
45	568	558	522	498	486	491
55	389	381	359	333	328	417
65	239	226	211	197	189	310
75	111	103	93	86	82	189
85	58	49	38	31	29	73
90	10	7	2	1	1	

**COEFFICIENTS OF UTILIZATION (%)**

Ceiling	80			70			50				
	70	50	30	10	70	50	30	10	50	30	10
Wall	70	50	30	10	70	50	30	10	50	30	10
0	66	66	66	66	65	65	65	65	62	62	62
1	61	59	56	54	60	57	55	53	55	53	52
2	56	52	48	45	54	51	47	44	49	46	43
3	51	46	41	38	50	45	41	38	43	40	37
4	47	41	36	33	46	40	36	32	39	35	32
5	44	37	32	28	42	36	32	28	35	31	28
6	40	33	29	25	39	33	28	25	32	28	25
7	38	30	26	22	37	30	26	22	29	25	22
8	35	28	23	20	34	28	23	20	27	23	20
9	33	26	21	18	32	25	21	18	25	21	18
10	31	24	20	17	30	24	19	17	23	19	17

Based on floor reflectance of 20

**LUMINANCE DATA (CD/M<sup>2</sup>)**

Vertical Angle	Horizontal Angles		
	0	45	90
45	12718	5726	4494
55	10724	4095	3074
65	9109	2687	1957
75	7431	1529	1066
85	5100	433	251

**i** All IES files for other lamping are available for download at: [www.axislighting.com](http://www.axislighting.com)

● **PHOTOMETRIC DATA**

I T8

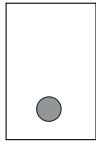

**PHOTOMETRIC CURVE**

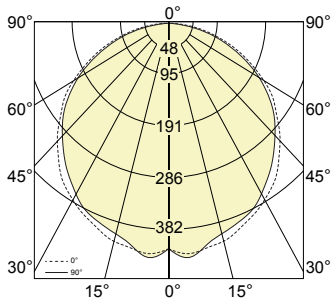

**Test Lamp: 1xF32T8**  
 IES FILE: BDR-S-4-T8-1

**Efficiency: 41.9%**

**CANDELA DISTRIBUTION**

Vertical Angle	Horizontal Angles					Zonal Lumens
	0	22.5	45	67.5	90	
0	412	412	412	412	412	
5	422	423	425	417	429	23
15	409	404	410	400	395	97
25	379	376	372	371	370	160
35	342	333	329	325	325	201
45	287	281	279	277	275	216
55	231	225	225	217	219	206
65	159	159	154	151	150	167
75	89	86	85	82	81	106
85	28	25	21	17	16	40
90	5	3	1	0	0	

**COEFFICIENTS OF UTILIZATION (%)**

Ceiling	80			70			50				
	70	50	30	10	70	50	30	10	50	30	10
Wall	70	50	30	10	70	50	30	10	50	30	10
0	50	50	50	50	49	49	49	49	47	47	47
1	46	44	42	40	44	43	41	39	41	39	38
2	41	38	35	33	40	37	34	32	36	33	31
3	38	33	30	27	37	33	29	27	31	28	26
4	34	29	26	23	33	29	25	23	28	25	22
5	32	26	22	20	31	26	22	19	25	22	19
6	29	24	20	17	28	23	20	17	22	19	17
7	27	21	18	15	26	21	17	15	20	17	15
8	25	19	16	13	25	19	16	13	19	15	13
9	24	18	14	12	23	18	14	12	17	14	12
10	22	16	13	11	22	16	13	11	16	13	11

Based on floor reflectance of 20

**LUMINANCE DATA (CD/M<sup>2</sup>)**

Vertical Angle	Horizontal Angles		
	0	45	90
45	5266	2510	2077
55	5065	2028	1614
65	4533	1430	1115
75	3760	840	623
85	2454	231	133

I T8

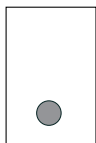

**PHOTOMETRIC CURVE**

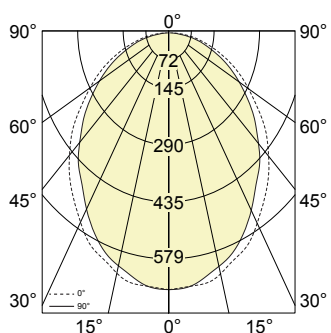

**Test Lamp: 1xF32T8**  
 IES FILE: BDR-F-4-T8-1

**Efficiency: 49.6%**

**CANDELA DISTRIBUTION**

Vertical Angle	Horizontal Angles					Zonal Lumens
	0	22.5	45	67.5	90	
0	652	652	652	652	652	
5	645	643	649	639	645	35
15	604	594	591	595	588	143
25	530	526	513	499	494	223
35	439	426	413	406	400	259
45	344	331	317	308	304	254
55	244	240	230	221	216	218
65	163	156	150	142	139	164
75	89	85	80	76	75	101
85	30	26	21	18	16	39
90	6	4	1	1	1	

**COEFFICIENTS OF UTILIZATION (%)**

Ceiling	80			70			50				
	70	50	30	10	70	50	30	10	50	30	10
Wall	70	50	30	10	70	50	30	10	50	30	10
0	59	59	59	59	58	58	58	58	55	55	55
1	54	52	50	48	53	51	49	47	49	47	46
2	50	46	43	40	48	45	42	39	43	41	38
3	46	41	37	34	44	40	36	33	38	35	33
4	42	36	32	29	41	36	32	29	34	31	28
5	39	33	28	25	38	32	28	25	31	27	25
6	36	30	25	22	35	29	25	22	28	25	22
7	33	27	23	20	33	27	23	20	26	22	20
8	31	25	21	18	30	24	20	18	24	20	18
9	29	23	19	16	29	22	19	16	22	18	16
10	27	21	17	15	27	21	17	15	20	17	15

Based on floor reflectance of 20

**LUMINANCE DATA (CD/M<sup>2</sup>)**

Vertical Angle	Horizontal Angles		
	0	45	90
45	6304	2855	2301
55	5352	2072	1589
65	4632	1389	1031
75	3768	789	580
85	2576	230	135

**i** All IES files for other lamping are available for download at: [www.axislighting.com](http://www.axislighting.com)